

# LOADCELL SUPPLIES

## Model WLFN2 Series

Specially designed for protecting cranes from overload and for measuring the tension of wireropes.(500kg ~ 10t/Rope)



In many industrial applications the tension in wire rope needs to be carefully and continuously monitored.

Usually all load cells placed in series with the rope, either at a point along its length or more commonly between the end of the rope and the fixture. The problem is that such a load cell is best suited to new application where it is designed in at an early stage

### SPECIFICATIONS

MODEL	WLFN2
Rated capacity (R.C.)	500kg, 1, 1.5, 2.5, 4, 8, 10t/Rope
Rated output(R.O.)	Approx. 1.0mV/V
Non-linearity	≤1.0% R.O.
Hysteresis	≤1.0% R.O.
Non-repeatability	≤1.0% R.O.
Creep error	≤1.0% in 20min.
Zero balance	≤1% R.O.
Compensated temperature range	-10 ~ 70°C
Operating temperature range	-20 ~ 80°C
Temp. effect on rated output	≤0.05% LOAD/10°C
Temp. effect on zero balance	≤0.05% R.O./10°C
Terminal input resistance	350 Ohms ± 3.5 Ohms
output resistance	350 Ohms ± 5 Ohms
Insulation resistance (Min.)	2000 MOhms at 50V DC
Recommended excitation	10V(Recommended), 15V(Max.)
Electrical connection	∅7mmx3m(22AWG x 4Core Shielded)
Protection class	meets IP 64
Safe overload	200% R.C
Ultimate overload	400% R.C

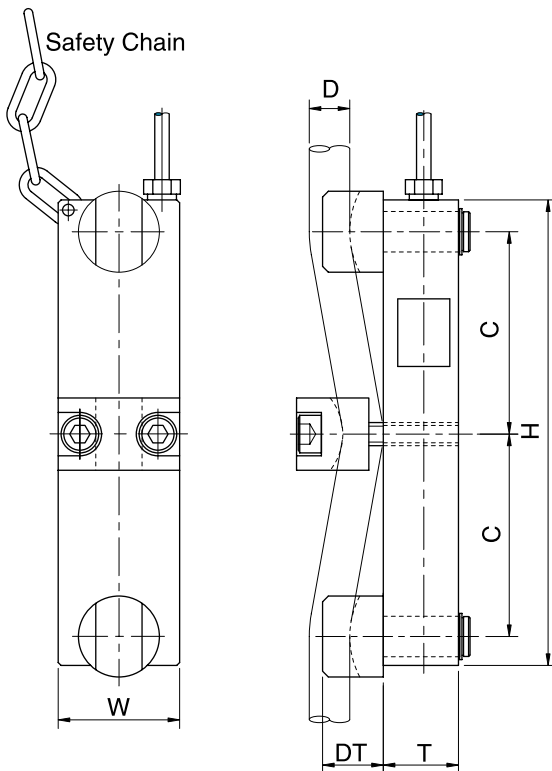

### ORDERING INFORMATION

#### WLFN2 - 10T

MODEL WLFN2	CAPACITY 500kg, 1, 1.5, 2.5, 4, 8, 10ton/Rope
----------------	---

### WIRING INFORMATION

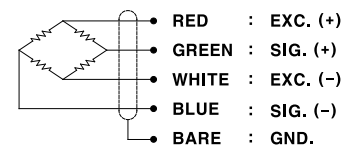

Dimension-mm

Rated Capacity	C	DT	H	T	W	∅D Wire rope	Weight (kg)
0.5t, 1t	60	15.5	140	20	34	∅ 6 ~ ∅ 8	1.0
1.5t	70	21	160	26	42	∅ 10 ~ ∅14	1.9
2.5t	75	25	180	32	50	∅ 14 ~ ∅20	2.9
4t	90	35	210	32	62	∅ 18 ~ ∅28	5.2
8t, 10t	100	45	260	44	88	∅ 25 ~ ∅35.5	12.0

Rated Capacity : Max. Load per wire rope

\* Specifications are subject to change without notice